

## Plasterboard and Cavity Fasteners

These anchors are not recommended for structure critical applications and are typically used for simple fixing and finishing applications. Their capacity information is therefore presented in simple Working Load Limit format.

### Togglemates

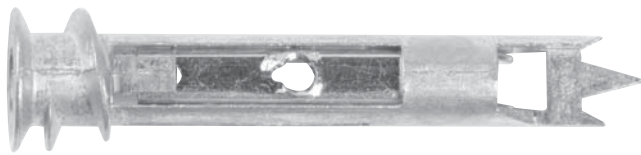

#### Function

For fixing of: picture hanging, shelves, brackets, towel rails.  
Material: Zinc die cast.

#### Product Advantages

- Self drilling.
- Self clamping of anchor.
- All metal body.
- Screw can be removed without losing anchor.
- Strongest plasterboard anchor.
- Loading Light: 20kg
- Wall thickness: 10-13mm
- Screw size: 8g

#### Installation

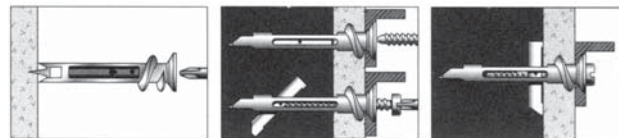

1. Lightly pierce plaster-board, with a phillips head screwdriver simply screw Togglemate into plasterboard.
2. Position fixture and insert screw. Turn screw to engage the clamp.
3. Continue to turn screw until clamp is pulled tight against plasterboard.



Sg Screw Gauge x SL Minimum Screw Length	Working Load Limit (kg)	Wt Wall Thickness	Order No.
8 x 20	20	10 - 13mm	TM8

### Wallmate - Metal



#### Function

Self drilling plasterboard anchor for walls with cavities.  
Material: Zinc die cast.

#### Product Advantages

- Self drilling.
- All metal body.
- Screw can be removed without losing anchor.
- Will not shrink or degrade due to UV exposure.
- Wall thickness: 5-10mm
- Screw size: 8g

#### Installation

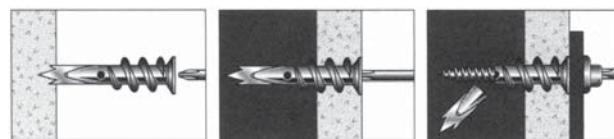

1. Place on the end of your phillips head screwdriver and then lightly pierce the plaster-board face paper where the anchor is to be fixed.
2. Only light pressure is required. Simply screw the Wallmate into the plasterboard.
3. Now using an 8 gauge screw through fixture, screw into wallmate.

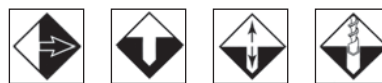

Sg Screw Gauge x SL Minimum Screw Length	Working Load Limit (kg)	Wt Wall Thickness	Order No.
8 x 20	10	10 - 13mm	WM8BK

## Plasterboard and Cavity Fasteners

These anchors are not recommended for structure critical applications and are typically used for simple fixing and finishing applications. Their capacity information is therefore presented in simple Working Load Limit format.

### Wallmate - Nylon

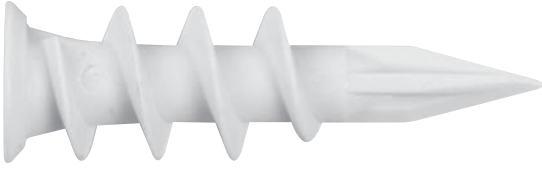

#### Function

Self drilling plasterboard anchor for walls with cavities.  
Material: Glass reinforced nylon.

#### Product Advantages

- Non conductive.
- Self drilling.
- Screw can be removed without losing anchor.
- Centre drill point enables straight fix.
- Wall thickness: 5-10mm
- Screw size: 6g

Sg Screw Gauge x SL Minimum Screw Length	Working Load Limit (kg)	Wt Wall Thickness	Order No.
6 - 7 x 20	10	10-12mm	WM6T
6 - 7 x 20	10	10-12mm	WM6P
6 - 7 x 20	10	10-12mm	WM6BK

#### Installation

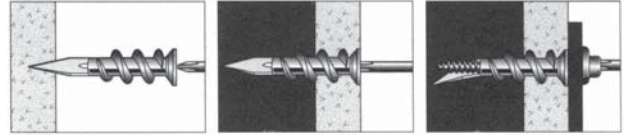

1. Lightly pierce the plasterboard face paper with the Wallmate.
2. Wallmate will easily screw into the plasterboard. Screws up tight for a smooth flush finish.
3. Secure the fitting with a 6-7 gauge screw. The “push away” point allows any length screw to be used.



### Hollow Wall Anchors



#### Function

For fixing of: electrical fittings, shelves, brackets, pipe saddles.  
Material: Pressed steel, carbon steel screw.

#### Product Advantages

- Flush finish, low profile head.
- Anti-rotation bars on head flange.
- Screw can be removed without losing the anchor.
- Can be set with a setting tool where large numbers used.

do Thread Size	do Hole Ø	Wt Wall Thickness	Working Load Limit (kg)	Order No.
M4	8	8 - 13	10	HW13M4
M4	8	16 - 24	10	HW24M4
M5	9	7 - 14	10	HW14M5
M6	13	6 - 16	10	HW16M6
Hand Setting Tool				SETHWG

#### Installation

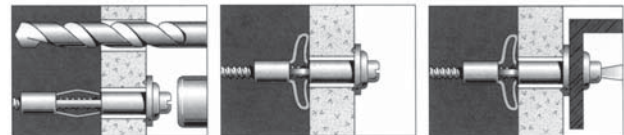

1. Drill the correct size hole through the material then tap the hollow wall anchor into the hole until its flush with the surface.
2. Turn the screw with a suitable screwdriver to expand the anchor.
3. Remove the screw and place through the hole in the fixture and back into the hollow wall anchor and tighten the screw.



## Plasterboard and Cavity Fasteners

These anchors are not recommended for structure critical applications and are typically used for simple fixing and finishing applications. Their capacity information is therefore presented in simple Working Load Limit format.

### Ramtoggle



#### Function

For fixing of: curtain tracks, cupboard hooks, notice boards, pictures, light duty fixings. Material: Nylon.

#### Product Advantages

- Suitable for cavity and solid wall applications.
- Wide wingspan for maximum holding power.
- Anti-rotation fins.
- Non-conductive.

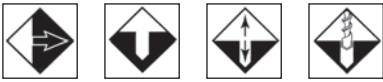

#### Installation

##### Solid Installation



1. Drill correct size hole.
2. Cut the wings at the "elbow" joint.
3. Push the cut wings together, insert into the hole. Tap home with a hammer, insert the screw through the fixture and tighten.

##### Cavity Installation

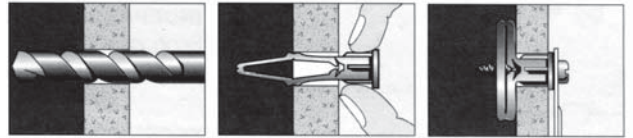

1. Drill the correct size hole through plasterboard, etc.
2. Compress wings of the Ramtoggle and insert it into the hole. Tap with a hammer to ensure flush with the surface.
3. Insert the screw through the fixture, into the Ramtoggle and tighten.

do Hole Size	Sg Screw Gauge	Wt Wall Thickness	Working Load Limit (kg)	Type	Order No.
8	6-8	5-10mm	4	2	RT10
8	6-8	8-12mm	10	2	RT12

**Plasterboard and Cavity Fasteners**

These anchors are not recommended for structure critical applications and are typically used for simple fixing and finishing applications. Their capacity information is therefore presented in simple Working Load Limit format.

**Toggles**

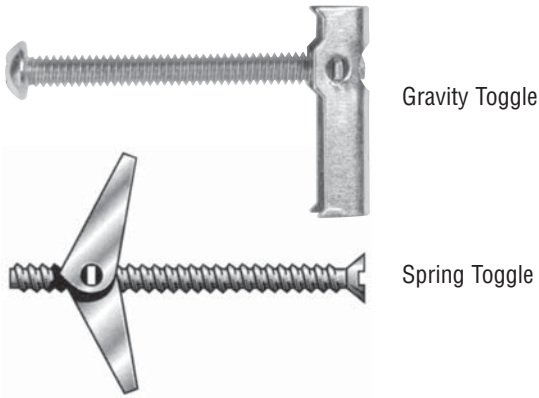

**Function**

For fixing of: towel rails, ceiling lights, shelf and cupboard installation. Material: Body - pressed steel, Screw - carbon steel.

**Product Advantages**

- Fire resistant.
- Good strength with wide wing span.



**Installation**

**Gravity Toggle**

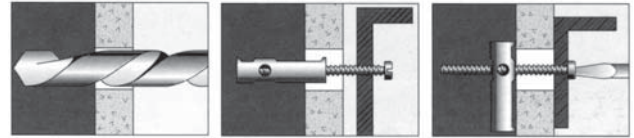

1. Drill the correct size hole through the material to which the fixture is to be fastened.
2. Pass the screw through the fixture and into the toggle for a few turns. Insert the toggle through the hole in the material.
3. Pull back on the fixture to hold the toggle in place against the reverse side of the material and tighten the screw with a screwdriver.

**Spring Toggle**

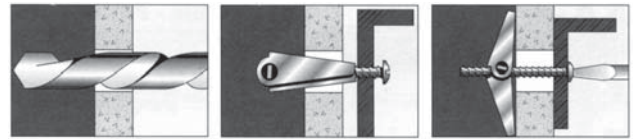

1. Drill the correct size hole through the material to which the fixture is to be fastened.
2. Pass the screw through the fixture and into the toggle for a few turns. Insert the toggle through the hole in the material.
3. Pull back on the fixture to hold the toggle in place against the reverse side of the material and tighten the screw with a screwdriver.

do Hole Size	d <sub>s</sub> Screw Thread Size x SL Screw Length (mm)	Head Style	Working Load Limit (kg)	Type	Order No.
7/16"	1/8" x 50	Phillips	8	Spring	STR04050
9/16"	3/16" x 50	Phillips	10	Gravity	GTR05050
9/16"	3/16" x 75	Phillips	10	Spring	STR05075
9/16"	3/16" x 50	Hook	10	Spring	STK05050

## Plasterboard and Cavity Fasteners

These anchors are not recommended for structure critical applications and are typically used for simple fixing and finishing applications. Their capacity information is therefore presented in simple Working Load Limit format.

### Plastic Toggle



#### Function

Lightweight plasterboard and particle board fixing.

#### Product Advantages

- Anti-rotation fins.
- Non-metal body is non-conductive.
- Accepts self-tapping screws.

#### Installation

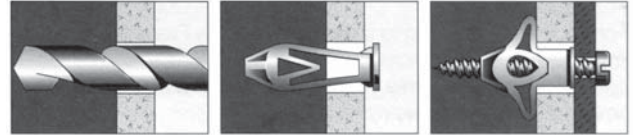

1. Drill 8mm hole through the plasterboard.
2. Insert the Plastic Toggle and tap with a hammer to ensure it is flush with the surface.
3. Place a suitable self-tapping screw through the object to be fastened. Insert into the Plastic Toggle and tighten the screw.

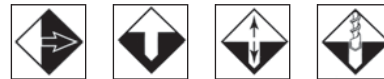

do Hole Size	Sg Screw Gauge	Wt Wall Thickness	Working Load Limit (kg)	Type	Order No.
8	6-8	10-12mm	5	1	LP12

### Electrical Support Clips

#### DynaClip™ Spring Steel Clips

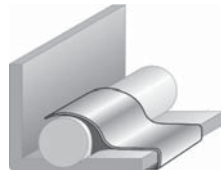

Installation example

Fastens Cable	Flange Thickness	Type	Order No.
6-10	2-8mm	Dynaclip	DK10
16 - 20	2 - 10mm	Dynaclip	DK20
25 - 32	2 - 10mm	Dynaclip	DK32

#### Vertical Flange Clip



Installation example

Flanges	Flange Thickness	Type	Order No.
1.6-2.5mm	7mm	Vertical flange clip	VF1