

Brick and Block Anchoring



Function

ChemSet Injection 101 is a medium duty, peroxide initiated injection anchor.

Features and Benefits

Fast installation:

- Load in 1 hour (at 20°C).

Versatile:

- Suitable for anchoring into pre-manufactured masonry units.

Principal Applications into Brick and Block

- Installing wall mounted signs, handrails, and gates.

Performance Related

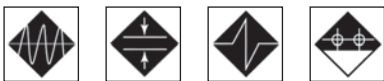

Material Specification



Installation Related



Installation

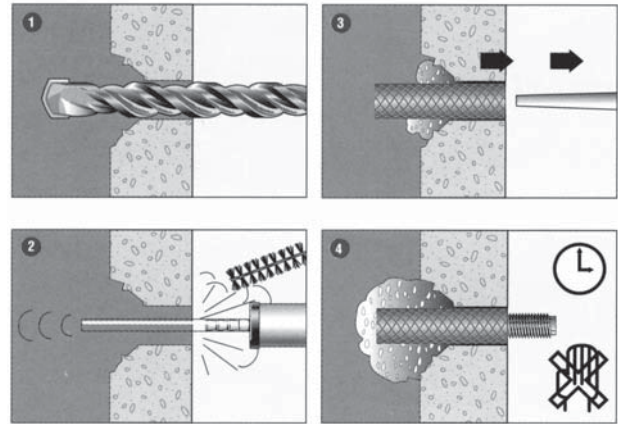

1. Drill recommended diameter and depth hole.
2. Clean hole with hole cleaning brush. Remove all debris using hole blower. Hole may be damp but no water present.
3. Insert mixing nozzle into sleeve or sieve. Fill to ¾ the sleeve / sieve depth slowly, ensuring no air pockets form. Insert Ramset ChemSet Anchor Stud to bottom of hole while turning.
4. ChemSet Injection to cure as per setting times. Attach fixture.

Installation temperature limits:

- Substrate: 0°C to 43°C
- Mortar: 15°C to 30°C

Load should not be applied to anchor until the chemical has sufficiently cured as specified in the following diagrams.

Service temperature limits:

- 10°C to 43°C.

Setting Times

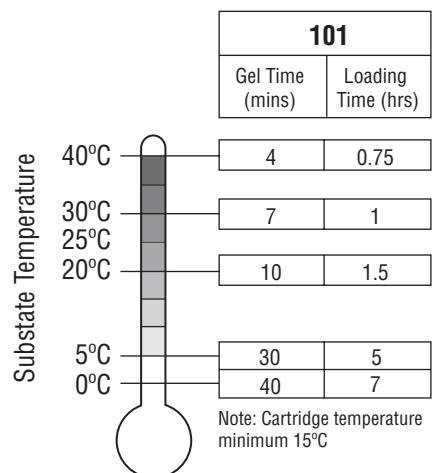

Brick and Block Anchoring

These anchors are not recommended for structure critical applications and are typically used for simple fixing and finishing applications. Their capacity information is therefore presented in simple Working Load Limit format.

Installation and Performance Details: Using Chemset Anchor Studs (p23)

Anchor size, d _a (mm)	Substrate	Sleeve/Sieve Type	Installation details				Performance (kN)	
			Drilled hole Ø, d _h (mm)	Fixture hole Ø, d _f (mm)	Anchor effective depth, h (mm)	Tightening Torque, T _r (Nm)	Solid Brick	
							Shear V _a (kN)	Tension N _a (kN)
M8	Solid Clay Brick	-	10	10	80	10z	4.4	1.4
M10			12	12	85	20	4.8	1.5
M12			14	15	85	40	5.2	1.6
M16			18	19	85	95	5.2	1.7

Anchor size, d _a (mm)	Substrate	Installation details				Performance (kN)					
		Drilled hole Ø, d _h (mm)	Fixture hole Ø, d _f (mm)	Anchor effective depth, h (mm)	Tightening Torque, T _r (Nm)	3 Hole Brick		10 Hole Brick		Concrete Block	
						Shear	Tension	Shear	Tension	Shear	Tension
M8	3 Hole Brick, 10 Hole Brick or Concrete Block	12	10	64	10	3.8	2.5	3.0	1.0	1.8	1.8
M10		16	12		20	4.6	2.5	4.6	1.0	2.0	1.8
M12		16	15		40	5.0	2.5	5.0	1.0	2.0	1.8
M16		22	19		95	5.0	2.5	5.0	1.0	2.0	1.8

* For details on Working Load Limit and Reduced Characteristic capacities refer page 3.

Working Load Limit

Description and Part Numbers

Description	Cartridge Size	Part No.
ChemSet 101 Cartridge	380 ml	C101C
Chemset Kit	2 x 380 ml	ISKP
Mixer Nozzle for 100 Series	-	ISNP
Applicator Tool	-	CUA
12mm Mesh Sleeve	-	ISM12
16mm Mesh Sleeve	-	ISM16

Description and Part Numbers - Accessories

Description		Part No.
Cleaning Brush	10-14mm Hole	HCBT13
Cleaning Brush	18-22mm Hole	HCBT20
Cleaning Brush	22-26mm Hole	HCBT26
Hole Cleaning Pump / Blower	-	S065990