

Brick and Block Anchoring

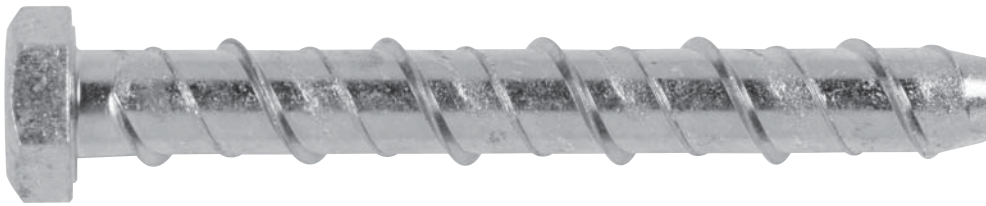

Function

The Anka Screw Anchor is a medium duty, rotation setting thread forming anchor.

Features and Benefits

Fast and easy to install:

- Simply screws into hole.

Fast and easy to remove:

- Screws out leaving an empty hole with no protruding metal parts to grind off.

Close to edge and for close anchor spacing:

- Does not expand and burst brick and block.

Performance Related



Material



Installation Related

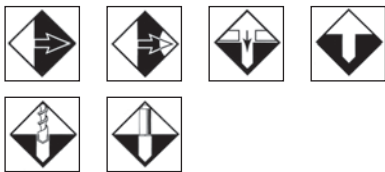

Installation

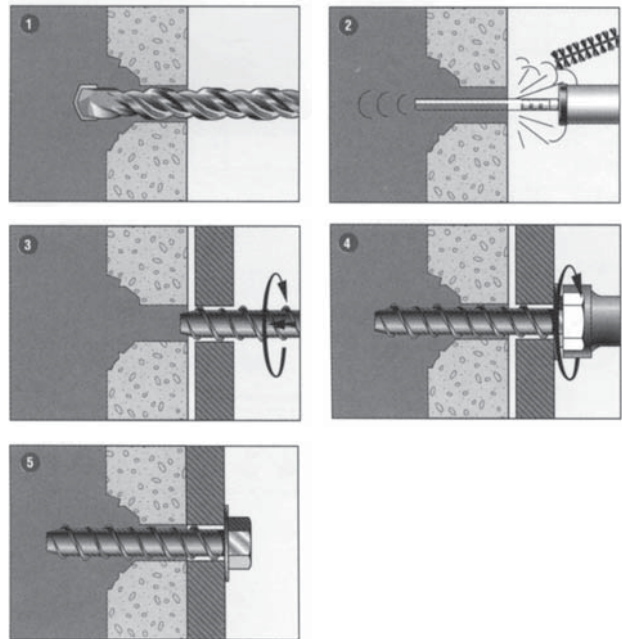

1. Drill hole to correct diameter and depth.
2. Clean thoroughly with brush. Remove debris by way of vacuum or hand pump, compressed air etc.
3. Using a socket wrench, screw the AnkaScrew into the hole using slight pressure until the self tapping action starts.
4. Tighten the AnkaScrew. If resistance is experienced when tightening, unscrew anchor one turn and re-tighten. Ensure not to over tighten.
5. For optimum performance, a torque wrench should be used.

Principal Application into Brick and Block

- Wall mounted pipe brackets
- Gate hinges
- Formwork
- Temporary fixings

Brick and Block Anchoring

These anchors are not recommended for structure critical applications and are typically used for simple fixing and finishing applications. Their capacity information is therefore presented in simple Working Load Limit format.

Installation and Performance Details

Anchor size, d_h (mm)	Installation details				Performance Limit (kN)					
	Drilled hole \varnothing, d_h (mm)	Fixture hole \varnothing, d_f (mm)	Anchor effective depth, h (mm)	Tightening Torque, T_r , (Nm)	3 Hole Brick		10 Hole Brick		Concrete Block	
					Shear V_a (kN)	Tension N_a (kN)	Shear V_a (kN)	Tension N_a (kN)	Shear V_a (kN)	Tension N_a (kN)
M6	6	8	30	10	3.0	2.4	1.8	0.60	2.1	0.90
M8	8	10	40	10	3.8	2.7	2.3	0.65	2.1	1.00
M10	10	12	50	15	4.2	2.8	2.5	0.65	2.1	1.00
M12	12	15	60	15	4.2	3.0	2.5	0.70	2.1	1.15
Working Load Limit										

* For shear loads acting towards an edge or where these minimum dimensions are not achievable, please use the simplified strength limit state design process to verify capacity.

* For details on Working Load Limit and Reduced Characteristic capacities refer page 3.

Description and Part Numbers

Anchor size, d_h	Length, L (mm)	Part No.
M6	50	AS06050H
	75	AS06075H
	100	AS06100H
M8	60	AS08060H
	75	AS08075H
	100	AS08100H
M10	60	AS10060H
	75	AS10075H
	100	AS10100H
	150	AS10150H
M12	75	AS12075H
	100	AS12100H
	150	AS12150H