

Light Weight Anchoring



Function

The ShureDrive Anchor is a light duty, impact setting interference fit anchor.

Features and Benefits

Convenient:

- Simply insert through fixture and hammer in.

Economical:

- Zinc body and Zinc Plated nail.

Secure:

- Tamper resistant head style.

Performance Related



Material



Installation Related

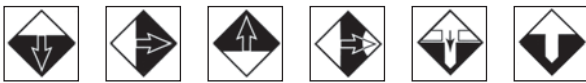

Installation

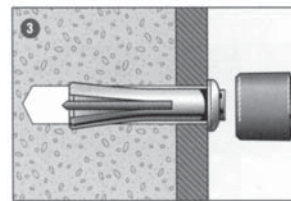
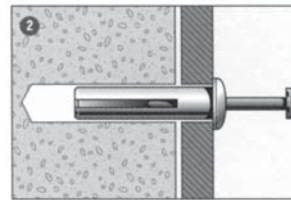
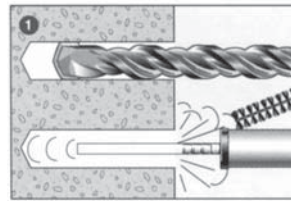

1. Drill hole to correct diameter and depth. Clean thoroughly with brush. Remove debris by way of vacuum or hand pump, compressed air etc.
2. Insert ShureDrive into hole through fixture until head is tight against fixture.
3. Drive home expansion nail with hammer.

Principal Applications

- Galvanised brick ties
- Signs
- Switch boxes
- Shelf brackets
- Flashings
- Down pipes
- Steel partitioning

Light Weight Anchoring

These anchors are not recommended for structure critical applications and are typically used for simple fixing and finishing applications. Their capacity information is therefore presented in simple Working Load Limit format.

Installation and Working Load Limit Performance Details

Anchor size, d_b (mm)	Installation details			Minimum dimensions*		Reduced Characteristic Capacity		
	Drilled hole \varnothing , d_h (mm)	Fixture hole \varnothing , d_f (mm)	Anchor effective depth, h (mm)	Edge distance, e_c (mm)	Anchor spacing, a_c (mm)	Shear V_s (kN)	Tension N_s (KN)	
						Concrete strength (MPa)		
							20 MPa	20 MPa
M5	5	6	19	20	30	1.0	0.8	0.8
M6	6	7	25	24	36	1.4	1.0	1.0
						Working Load Limit		

* For details on Working Load Limit and Reduced Characteristic capacities refer page 3.

Description and Part Numbers

Anchor size, d_b	Length, L (mm)	Part No.	
		Zn	S/S
M5	22	SDM05022	-
M6	30	SDM06030	SDM06030SS
	50	SDM06050	-

Light Weight Anchoring

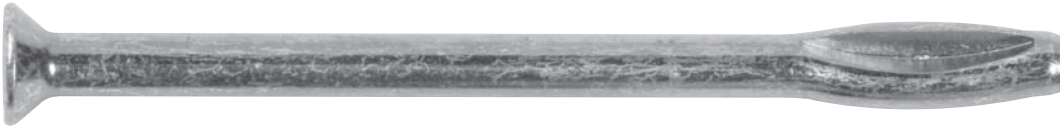

Function

The SplitDrive Anchor is a light duty, impact setting interference fit anchor.

Features and Benefits

Convenient:

- Simply insert through fixture and hammer in.
- For fixing to concrete, masonry and stone.
- Quick installation due to no secondary setting procedures being required.
- Large diameter head for greater pullover strength.

Economical:

- Zinc Plated nail.
- High strength anchor.

Secure:

- Tamper resistant head style.
- Vibration resistant.
- Hardened steel construction.

Performance Related



Material



Installation Related

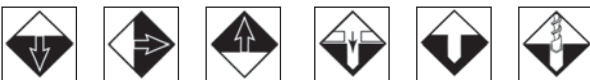

Installation

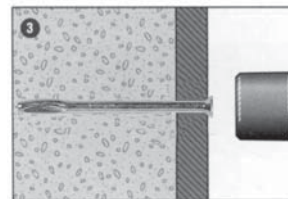
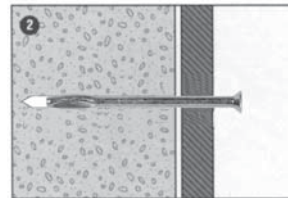
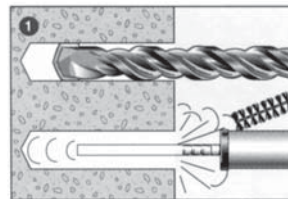

1. Drill hole to correct diameter and depth. Clean thoroughly with brush. Remove debris by way of vacuum or hand pump, compressed air etc.
2. Insert SplitDrive into hole through fixture and nail home against fixture.

Principal Applications

- Galvanised brick ties
- Signs
- Switch boxes
- Shelf brackets

Light Weight Anchoring

These anchors are not recommended for structure critical applications and are typically used for simple fixing and finishing applications. Their capacity information is therefore presented in simple Working Load Limit format.

SplitDrive Anchors

Anchor Size, d _b	Length, L (mm)	Minimum Embedment	Drill Diameter	Head Type	Performance (kN)		Order No.
					Tensile	Shear V _a (kN)	
M5	38	25	5.5	Mushroom	0.8	2.8	SDMH0538
M6	50	30	6.35 (1/4)**	Countersunk	2.2	3.5	SDCH0650
M6	75	30	6.35 (1/4)**	Countersunk	2.2	3.5	SDCH0675
M6	100	30	6.35 (1/4)**	Countersunk	2.2	3.5	SDCH06100

* For details on Working Load Limit and Reduced Characteristic capacities refer page 3.



Formwork Removable SplitDrive Anchors

Anchor Size, d _b	Length, L (mm)	Minimum Embedment	Drill Diameter	Head Type	Performance (kN)		Order No.
					Tensile	Shear, V _a (kN)	
M6	75	30	6.35 (1/4)*	Double	2.2	3.5	SDFW0675

* For details on Working Load Limit and Reduced Characteristic capacities refer page 3.



RediDrive™ Hammer In Anchors

Anchor Size, d _b	Length, L (mm)	Minimum Embedment	Drill Diameter	Head Type	Performance (kN)		Order No.
					Tensile 32 MPa	Shear V _a (kN)	
M5	40	25	5	Dome	2.5	4.6	RD05040
M5	50	30	5	Dome	3.6	4.9	R005050

* For details on Working Load Limit and Reduced Characteristic capacities refer page 3.



Catenary Wire Eye Knock In Anchors

Anchor Size, d _b	Length, L (mm)	Hole Depth	Drill Diameter	Head Type	Performance (kN)		Order No.
					Tensile	Shear, V _a (kN)	
M5	40	47	5	Tie wire	1.0 (100 kg)	-	CWE5040

* For details on Working Load Limit and Reduced Characteristic capacities refer page 3.

** 6-7mm depending on concrete hardness.

Light Weight Anchoring

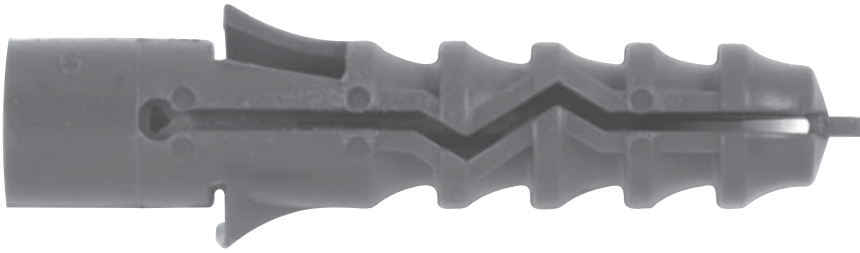

Function

The RamPlug Anchor is a light duty, rotation setting interference fit anchor.

Features and Benefits

Fast and Easy to Install:

- Anchor simply hammered in.

Convenient:

- Tags ensure anchor sits flush with substrate surface in over drilled holes.

Versatile:

- Anchor accepts many types of screws.

Performance Related

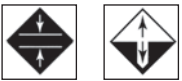

Material



Installation Related

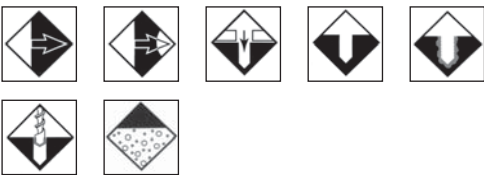

Installation

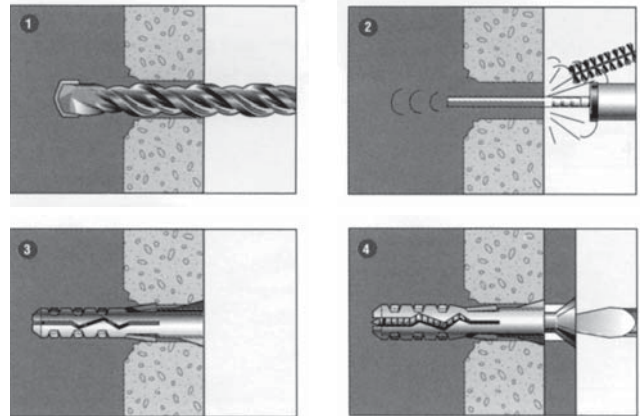

1. Drill hole to correct diameter and depth.
2. Clean thoroughly with brush. Remove debris by way of vacuum or hand pump, compressed air etc.
3. Insert the RamPlug into hole until flush with the surface.
4. Pass wood screw through fixture and into the RamPlug. Tighten with screwdriver.

Note: (1) Screw length = length Ramplug + thickness of fixture.

Principal Applications into Brick and Block.

- Electrical Fittings

Light Weight Anchoring

These anchors are not recommended for structure critical applications and are typically used for simple fixing and finishing applications. Their capacity information is therefore presented in simple Working Load Limit format.

Installation and Working Load Limit Performance Details

Anchor	Anchor size, d_b (mm)	Installation details			Minimum dimensions			Reduced Characteristic Capacity		
		Drilled hole \varnothing , d_h (mm)	Fixture hole \varnothing , d_f (mm)	Anchor effective depth, h (mm)	Edge distance, e_c (mm)	Anchor spacing, a_c (mm)	Substrate thickness, b_m (mm)	Shear V_a (kN)	Tension N_a (kN)	
									Concrete strength MPa	
								20 MPa	20 MPa	40 MPa
DNP05	5	5	6	25	20	30	50	0.4	0.3	0.3
DNP06	6	6	7	30	24	36	55	0.8	0.5	0.5
DNP07	7	7	7	30	28	42	55	1.1	0.65	0.65
DNP08	8	8	8	40	32	48	65	1.3	0.8	0.8
DNP10	10	10	9	50	40	60	75	2.4	1.2	1.2

* For details on Working Load Limit and Reduced Characteristic capacities refer page 3.

Working Load Limit

Description and Part Numbers

Anchor size, d_b (mm)	Length, L (mm)	Part No.
		Standard
M5	25	DNP05
M6	30	DNP06
M7	35	DNP07
M8	40	DNP08
M10	50	DNP10

Light Weight Anchoring



Function

The Nylon Anchor is a light duty, impact setting interference fit anchor.

Features and Benefits

Fast Installation:

- Anchor simply hammered or screwed in.

Versatile:

- Choice of head styles.

Corrosion resistant:

- Stainless steel nail.

Economical:

- Zinc plated nail.

Performance Related



Material



Installation Related

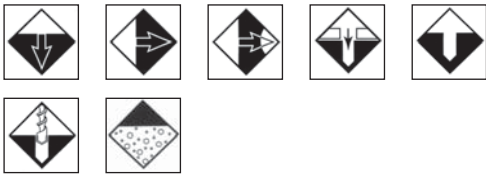

Installation

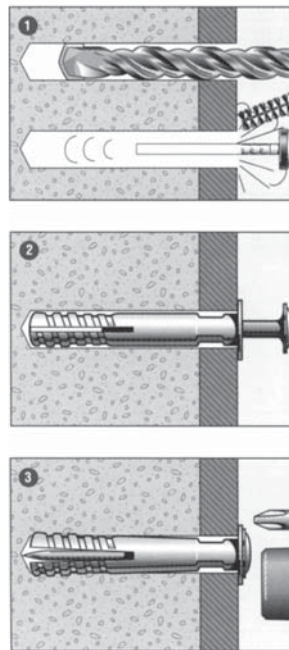

1. Drill hole to correct diameter and depth using fixture as template. Clean thoroughly with brush. Remove debris by way of vacuum or hand pump, compressed air etc.
2. Insert the nylon anchor into hole through fixture until head is tight against fixture.
3. Screw or tap home expansion nail with hammer. Expansion nail is easily removed with screwdriver.

Principal Applications

- Timber battens
- Skirting boards
- Electrical fittings
- External flashing
- Conduit brackets
- Shelf pipes

Light Weight Anchoring

These anchors are not recommended for structure critical applications and are typically used for simple fixing and finishing applications. Their capacity information is therefore presented in simple Working Load Limit format.

Nylon expansion anchors for use in solid concrete and masonry. Available in two configurations, the ED style being a removable anchor, incorporating a collapsible sleeve design, allowing for a positive pull-down of fixture. Most anchor types are available with a steel zinc plated or stainless steel expansion screw nail.

Anchor Range:

d Anchor size (mm)	L Anchor length (mm)	t For fixtures up to (mm)	do Hole ø x hL Hole depth (mm)	Performance (kN)		Nylon Anchor Order No.				EasyDrive Order No.
				Tensile	Shear	Mushroom head	Round head	Flat head	Countersunk head	
M5	20	2	5 x 25	0.20	0.50	TNM320	-	-	-	-
	25	5	5 x 30	0.20	0.50	TNM325	TNR325	TNL325	-	-
	33	6	5 x 40	0.20	0.50	-	-	-	-	ED05033SS
	38	13	5 x 40	0.20	0.50	-	TNR338	-	-	-
M6	42	12	6 x 50	0.30	0.75	-	-	-	-	ED06042♦
	55	25	6 x 50	0.30	0.75	-	-	-	-	ED06055♦
	70	40	6 x 50	0.30	0.75	-	-	-	-	ED06075♦
M6.5	25	5	6.5 x 30	0.30	0.80	TNM425	TNR425	-	-	-
	38	13	6.5 x 40	0.30	0.80	TNM438	TNR438	-	TNF438	-
	50	25	6.5 x 45	0.30	0.80	TNM450	TNR450	-	TNF450	-
	75	50	6.5 x 55	0.30	0.80	TNM475	-	-	TNF475	-
M8	120	75	8 x 95	0.40	1.00	-	-	-	-	ED08120

*For details on Working Load Limit and Reduced Characteristic capacities refer page 3.

Working Load Limit

♦ Available with stainless steel expansion nail. Add SS to end of Order No.

Light Weight Anchoring

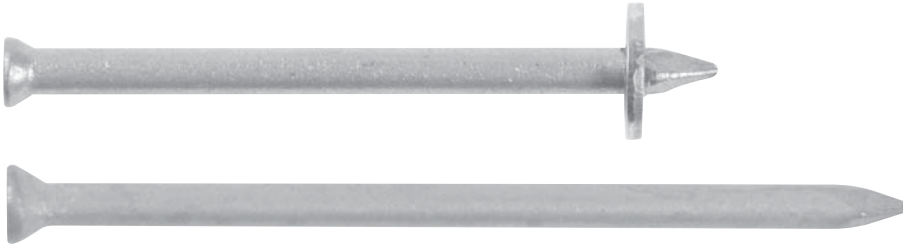

Function

For fixing to concrete, brick and concrete blockwork.

Features and Benefits

- High strength and ductile - will not easily break.
- Available pre-assembled with washers to improve pullover strength.
- Zinc electroplated with chromate conversion coating.
- Carbon Steel.

Principal Applications

- Formwork boards
- Timber batten
- Sheet metal signs
- Light gauge steelwork fixing to concrete

Concrete Nails

Anchor Size, d _h	Length, L (mm)	d _h Head Ø	Shank Style	Order No. Washer	Order No. No Washer
M2.4	25	4.5	Plain	CW425	CD425
	30	4.5	Plain	CW430	CD430
	40	4.5	Plain	CW440	CD440
M3.2	40	5.0	Plain	-	CD540
M3.8	50	6.0	Plain	-	CF650
	60	6.0	Plain	-	CF660
	75	6.0	Plain	-	CF675
	100	6.0	Plain	-	CF699
M6.5	70	14.0	Plain	-	CR970

Light Weight Anchoring



Function

The Ramset Plastic Spaghetti is a versatile and easy way to make effective, reliable and strong anchors. Suitable for nails or screws. Minimum diameter 3.75mm.

Product Advantages

- Light duty application.
- Economic simple fixing.
- Quick installation. Nail or Screw in.
- Cut to required length.
- Economical roll.

Principal Applications

- Concrete
- Brick
- Hollow Brick
- Stone

Installation

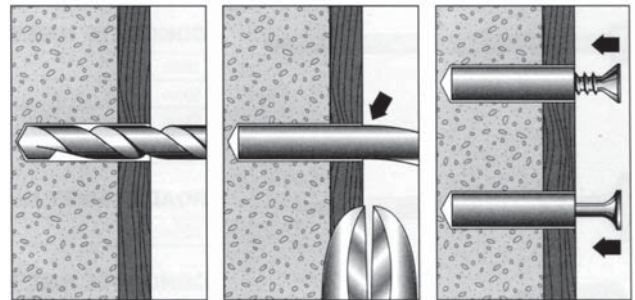

1. Drill a 5.5mm diameter hole to required depth.
2. Clean hole of dust and insert Spaghetti through fixture into hole and cut off.
3. Insert screw or nail and fasten firmly.

Plastic Spaghetti

Drill Size	Roll Length	Order No. (50m Roll)
5.5	50 m	RSP

Light Weight Anchoring



Function

An inexpensive traditional expansion plug for use with screws.

Product Advantages

- Colour Coded indicates the plug size
- Frame Packed for convenient storage
- Inexpensive
- Corrosion resistant
- Light Weight

Principal Applications

- Concrete
- Brick
- Hollow brick
- Stone

Installation

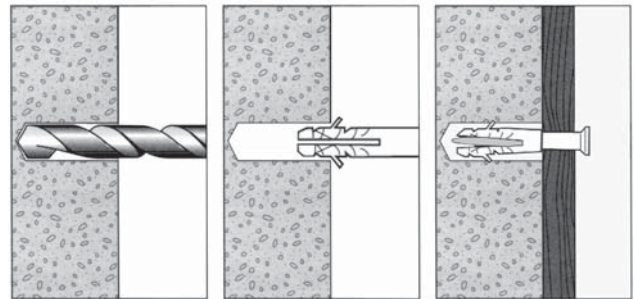

1. Drill hole in substrate.
2. Insert fixing into the hole.
3. Using a screwdriver screw the screw through fixture into fixing until fix has been achieved.

Plastic Plugs

Hole Ø (mm)	Plug Length, L (mm)	Colour	Order No.
M5	25	White	RWPW25
M5	35	White	RWPW35
M6	25	Red	RWPR25
M6	35	Red	RWPR35
M7	25	Green	RWPG25
M7	35	Green	RWPG35
M8	35	Blue	RWPB35